

KEY

- Carriageway
- Footway
- Footway/Cycleway
- Water
- Verge
- Landscaping/ Low Level Planting
- Embankment
- Hard Standing
- Fence/Safety Barrier
- Proposed Boundary
- Highway Boundary

- NOTES**
- ASSUMPTIONS FOR THE DESIGN:**
1. Horizontal Alignment as per approved Departures and Exceptions and RSA Stage 1.
 2. Avon Mill Lane options depend on Land Ownership of existing fenced area.
 3. Existing Bridge to be retained.
 4. Proposed footbridge and bridge raised levels to account for 100y storm + 40% climate change.
 5. Shared use 4m wide footway from Hunter's Lane to Leicester Road Toucan Crossing.

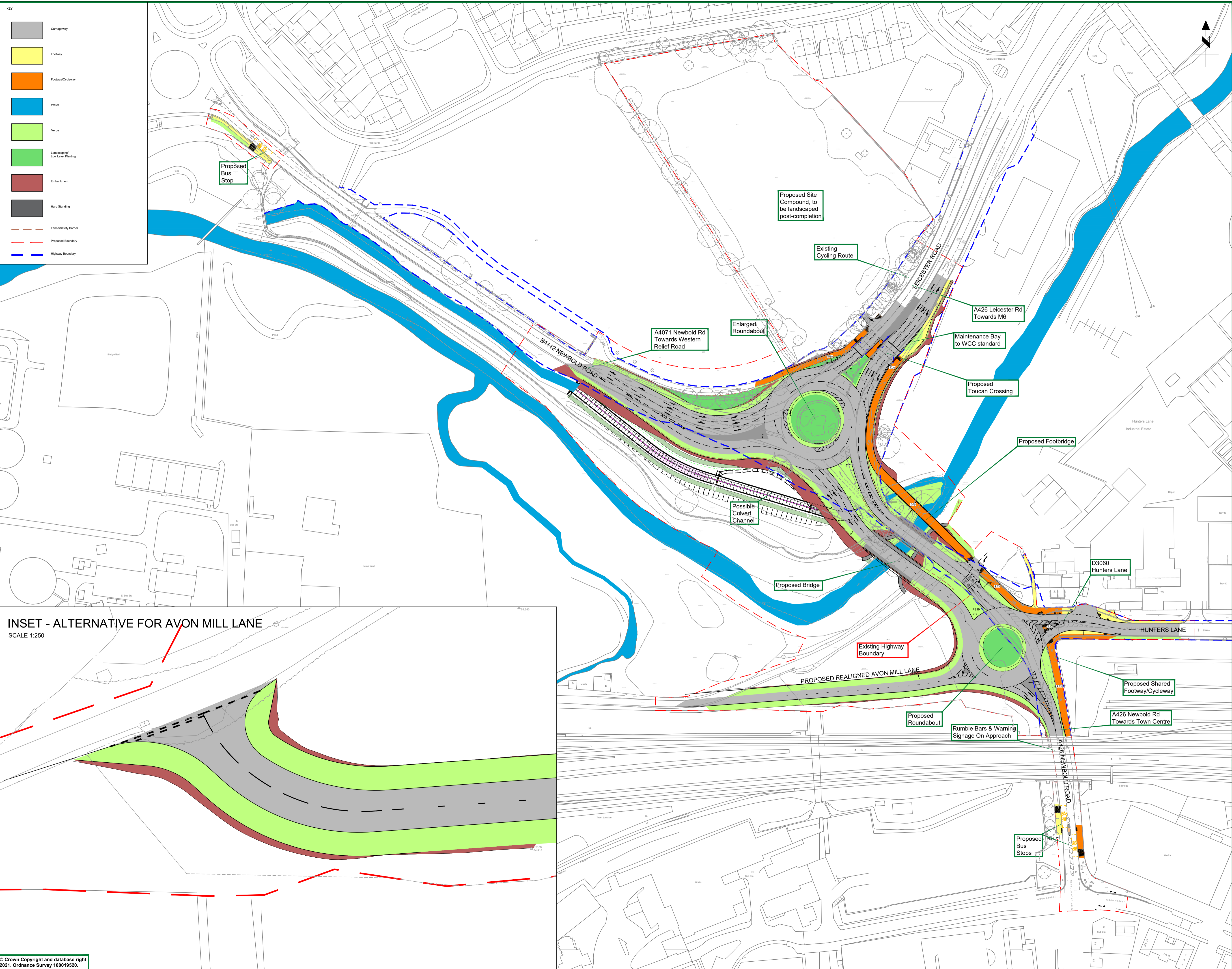

| | | | |
|-----|-----|---------------------|----------|
| A | EMF | RSA Stage 1 updates | 08/09/22 |
| REV | DRN | AMENDMENT | DATE |



Engineering Design Services
Environment Services, Communities
Shire Hall Post Room
Warwick
CV34 4SP
Tel: 01926 410410
Web: www.warwickshire.gov.uk

bsi
UKAS
FS 26655

C:\DesignServices\9.2333\0103 Drawings\3-01 AutoCAD\9.2-333-010-6001.dwg

PROJECT
A426/A4071 Avon Mill and Hunters Lane
Improvement Scheme

TITLE
Conceptual Layout 1
Scheme Layout Plan
Design Phase: Concept Design

| | | | | | |
|------|----------|------|----------|-------|----------|
| Dim | EM | CK'd | AC | App'd | AC |
| Date | 24-01-22 | Date | 22-09-22 | Date | 22-09-22 |

Status: **Approved (Level 2)**

Scale: 1:1000 Sheet size: A1

DRG. NO. 9.2-333-010-6001 Rev. A